

FED. ROAD DIST. NO.	STATE	JOB PIECE NO.	FISCAL YEAR	SHEET NO.	TOTAL SHEETS
6	OKLA.	27050(04)	2017		

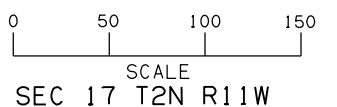

LEGEND

- PROPOSED PAVEMENT
- PROPOSED RAISED MEDIAN
- PAVEMENT PATCH
- DRAINAGE STRUCTURE

STA. 68+57 LT. 416+99.2
C.D.I. 25'X15' X5.0
TOP GRADE = 1135.48
E. ELEV. 13035.85
E. 18' RCP (NORTH) - 1130.55
STA. 416+54.75 93.63' LT.
C.D.I. 30'X30' X2.5
TOP GRADE = 1130.67
E. ELEV. 1128.00
E. 18' RCP (EAST) - 1128.00
E. 18' RCP (SOUTH) - 1128.01
STA. 419+84.12 21' RT.
TOP GRADE = 1134.66
E. ELEV. 1131.43
E. 18' CGMP (SOUTH) - 1131.43
END 18' CGMP (SOUTH) - 1130.79
STA. 417+83.50 75.33' LT.
C.D.I. 30'X30' X3.0
TOP GRADE = 1130.73
E. ELEV. 1128.01
E. 18' RCP (NORTH) - 1128.07
E. 18' RCP (WEST) - 1128.09
REMOVE

STA. 417+87.15
18' X106.41 RCP *X* DRAIN
7.56' LT. & 32.01' RT.
E. ELEV. = 1128.07' LT. & 1127.01' RT.

STA. 419+56.50 8.20' RT.
C.D.I. 25'X15' X3.5'
TOP GRADE = 1127.15
E. ELEV. = 1123.79
E. 18' RCP (SOUTH) - 1123.56
END 18' RCP (SOUTH) - 1123.54
E. 18' RCP (NORTH) - 1123.96
REMOVE

STA. 419+57.25 18' X56.71
LONG RCP *X* DRAIN
49.19' LT. & 7.41' RT.
E. ELEV. = 1123.93' LT. & 1123.86' RT.

STA. 419+60.12 50.02' LT.
C.D.I. 25'X15' X3.5'
TOP GRADE = 1127.37
E. ELEV. = 1123.93
E. 18' CGMP (NORTH) - 1123.89
END 18' CGMP (NORTH) - 1125.51
E. 18' RCP (SOUTH) - 1123.93
REMOVE

STA. 420+09.69
18' X307 X64.96 CGMPA *X* DRAIN
46.74' LT. & 18.21' RT.
E. ELEV. = 1123.65' LT. & 1123.34' RT.

Sta. 420+10.09
C.D.I. 4-25'X15'X3.83'
47.95' RT. & 4-25'X10.35' Curb Inlets
Top Curb = 1127.81
Top Grade = 1127.28
E. ELEV. = 1123.45
E. 30' CGMPA (North) - 1123.66
E. 30' CGMPA (North) - 1123.66
END 30' CGMPA (NORTH) - 1124.92

STA. 422+41.70 40.46' LT.
C.D.I. 4-25'X15'X4'
TOP OF GRADE = 1128.72
E. ELEV. = 1124.63
E. 18' RCP (WEST) - 1124.61
E. 18' RCP (EAST) - 1124.65

SEC 18 T2N R11W

SEC 17 T2N R11W

STA. 51+25.00
BEGIN CONSTRUCTION ROGERS LANE

STA. 61+70.92
END CONSTRUCTION ROGERS LANE

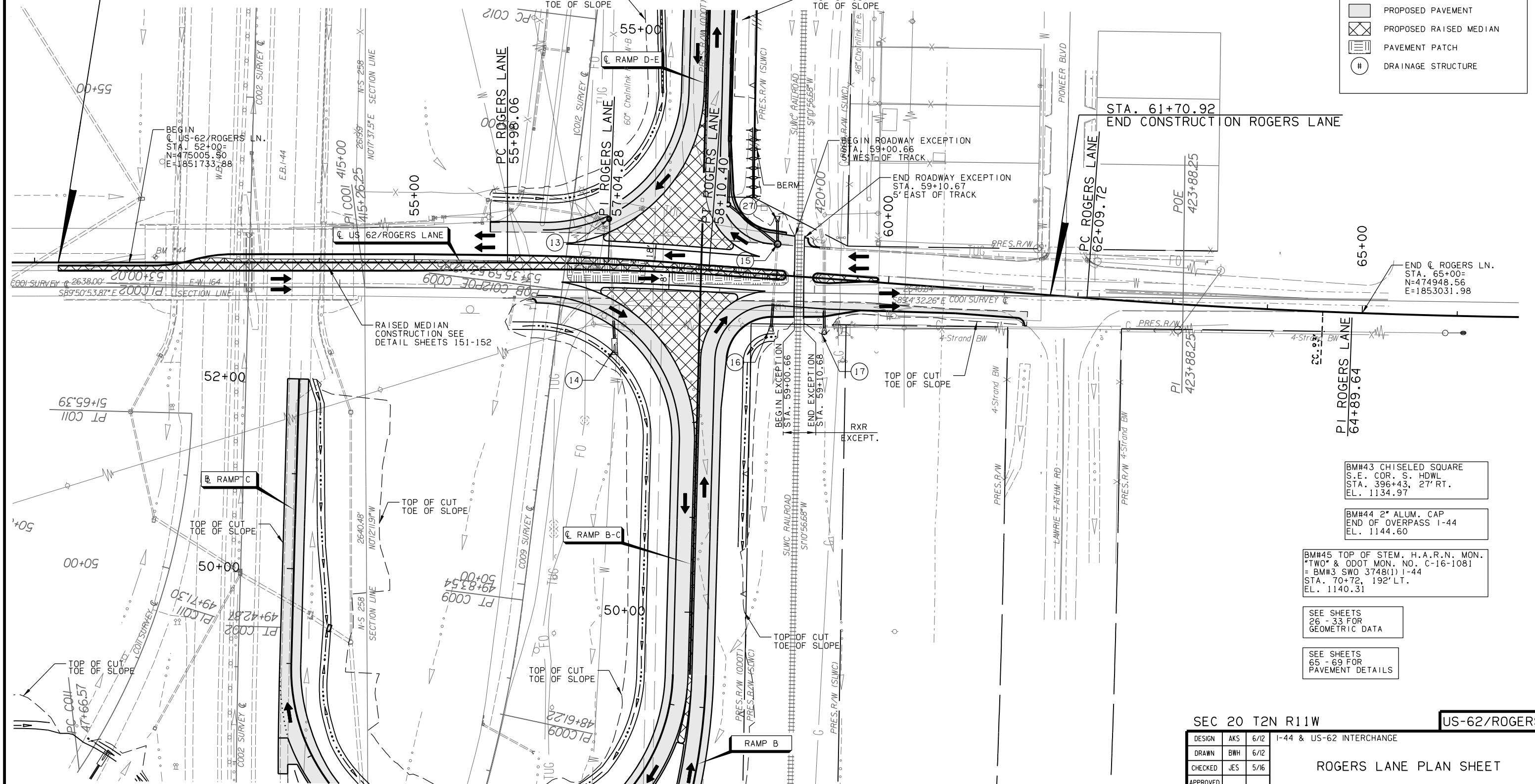

SEC 19 T2N R11W

SEC 20 T2N R11W

SEC 20 T2N R11W
US-62/ROGERS

DESIGN	AKS	6/12	1-44 & US-62 INTERCHANGE
DRAWN	BWH	6/12	
CHECKED	JES	5/16	
APPROVED			
SQUAD	GARVER	STATE JOB NO. 27050(04)	SHEET NO. 48

ROGERS LANE PLAN SHEET

BM#43 CHISELED SQUARE
S.E. COR. S. HDWL
STA. 396+43, 27' RT.
EL. 1134.97

BM#44 2" ALUM. CAP
END OF OVERPASS I-44
EL. 1144.60

BM#45 TOP OF STEM. H.A.R.N. MON.
"TWO" & ODOT MON. NO. C-16-1081
= BM#3 SWO 3748(1) I-44
STA. 70+72, 192' LT.
EL. 1140.31

SEE SHEETS
26 - 33 FOR
GEOMETRIC DATA

SEE SHEETS
65 - 69 FOR
PAVEMENT DETAILS